

**Pipe Coupling model: Flex Grip - Open**

1. Available in S or L, short or long versions
2. Easily installed on pipes already in place
3. Opens with a hinge, for easy installation
4. 100% Tight seal for temporary repair
5. Good for repairing Metal, PE, FRP, GRP, PVC pipe
6. 316 Stainless Steel Coupling with EPDM, NBR seal

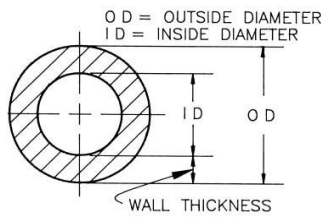
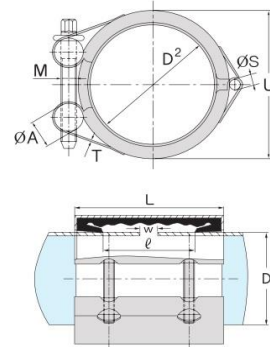

VITON or SILICONE

**Higher Bar pressures available**

OD	Pipe OD Range	Short length	Long Length	Pipe Gap (w) Short	Pipe Gap (w) Long	Maximum Bolt Tightness	Pressure	Estimated weight
(mm)	(mm)	(mm)	(mm)	(mm)	(mm)	(Nm)	Bar	(Kg)
21.3	19-23	57		5	n/a	15	32	0.35
26.9	24.9-28.9	57		5	n/a	15	32	0.4
33.7	31.7-35.7	57		5	n/a	15	32	0.5
42.2	38-44	57		5	n/a	15	32	0.6
48.3	46-50	57	100	5	30	30	32	0.65
60.3	58-62	80	139	5	15	30	32	1.4
73.0	71-75	80	139	5	30	30	32	1.5
88.9	87-91	107	203	5	30	50	28	3
114.3	104-118	107	203	5	30	50	28	3.3
141.3	139-143	116	203	5	30	80	28	3.3
168.3	166-170	116	203	5	40	80	24	5.1
219.1	217-221	155	255	10	40	100	16	11.8
273.3	271-275	155	255	10	40	100	16	13.1
323.9	322-326	155	255	10	40	100	14	13.5
355.6	353-357	155	255	10	40	100	14	18.2

Flex Grip 2 model available in sizes up to 4000.0mm

Any OD size can be manufactured

