

Pipe Coupling model: FLEX GRIP

1. Available in S or L, short or long versions
2. Non-axially restrained pipe coupling
3. Allows slight misaligned pipe connection
4. Allows vibration in the pipeline and slight movement
5. Good for connecting Metal, PE, FRP, GRP, PVC pipe
6. 316 Stainless Steel Coupling with EPDM, NBR, VITON or GORE-TEX seal

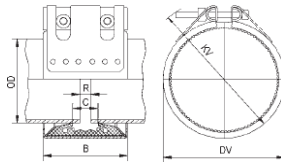
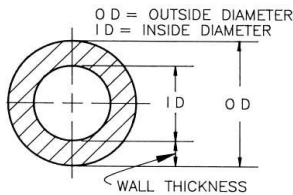

Higher Bar Pressures available

OD	Clamping Range	Short length	Long Length	Pipe Gap (R) Short	Pipe Gap (R) Long	Maximum Bolt Tightness	Pressure	Estimated weight
(mm)	(mm)	(mm)	(mm)	(mm)	(mm)	(Nm)	Bar	(Kg)
21.3	19-23	57	72	5	10	10	32	0.35
26.7	24-28	57	72	5	10	10	32	0.4
33.4	31-35	57	100	5	10	10	32	0.45
42.2	40-44	57	100	5	15	15	32	0.5
48.3	46-50	57	100	5	15	15	32	0.55
60.3	54-64	80	139	5	15	30	32	1.2
73	71-75	80	139	5	30	30	32	1.3
88.9	87-91	107	203	5	30	30	28	2.7
114.3	112-116	107	203	5	30	50	28	3.4
141.3	139-143	116	203	5	30	50	28	4.8
168.3	166-170	116	203	5	40	80	24	5.8
219.1	217-221	155	255	10	40	80	16	8.7
273.0	271-275	155	255	10	40	100	16	10.7
323.8	321-325	155	255	10	40	100	14	14.9
355.6	353-357	155	255	10	40	100	14	15.2
406.4	404-408	155	255	10	40	100	14	17.6
457.2	455-459	155	255	10	40	120	12	18.2
508.0	506-510	155	255	10	40	120	10	21.5

Flex Grip Open 2 model available in sizes up to 5000mm

Any OD size can be manufactured

