

Inline Duckbill Check Valve

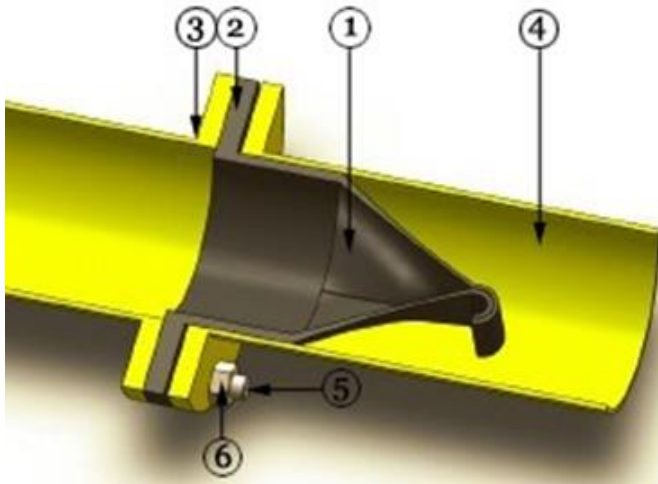

This is a rubber duckbill check valve for an in-line application. Installed inside a pipe internal diameter. The rubber flange is secured by being installed between two flanges, with the same flange specification.

Available in size range DN50 to DN600, any other sizes available on request.

The shape and dimensions can be changed to suit specific requests.

Flange drilling can be according to DIN PN10/16, ANSI 150LB, Table D/E and more.

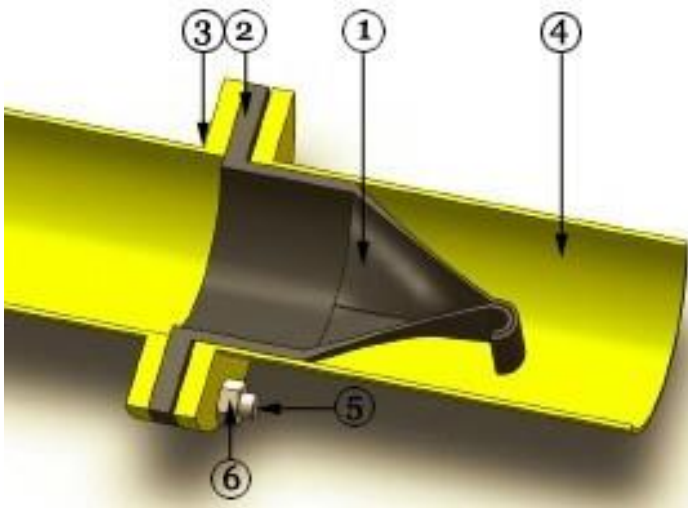

Item	Part	Material
1	Valve	Neoprene/EPDM/Nitrile
2	Rubber Flange	Neoprene/EPDM/Nitrile
3	Flange*	Steel/DI/PVC, etc.
4	Pipe*	Steel/DI/PVC/Concrete etc.
5	Bolt*	Not Supplied *Flange, pipe, bolt and nut are not supplied.
6	Nut*	Not Supplied*Flange, pipe, bolt and nut are not supplied.

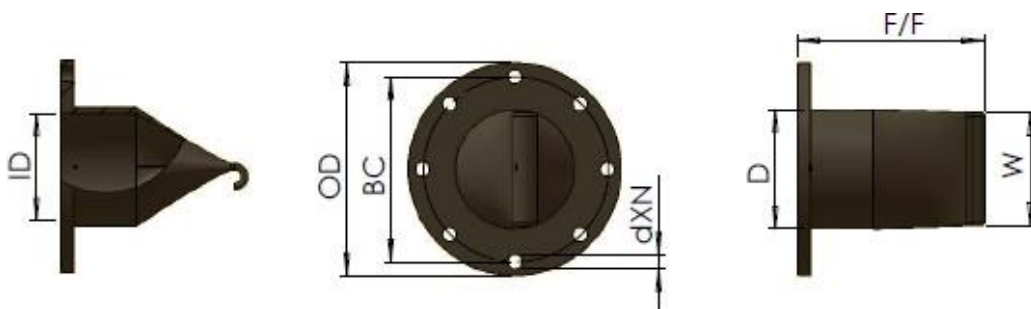

PIPE SIZE (mm)	Valve Dimensions (mm)							Working (bar)	Weight (kgs)
	F/F	OD	BC	d	N	D	W		
100	210	215	178	18	8	100	98	5	2.1
150	270	280	235	22	8	150	149	5	3.2
200	280	335	292	22	8	190.2	180	5	5.9
250	370	405	356	22	12	237.6	220	5	11.32
300	440	455	406	26	12	299.6	298	5	21.5
400	530	580	521	26	12	380.4	390	3	29.8
500	620	705	641	26	16	475.4	472	3	45.2
600	730	825	756	33	16	599.2	596	3	72.1