

## DB-2 Duckbill Check Valve - Flanged model



Curved end shown

The DB-2 Flanged model of Duckbill Check valve is available in two different models:

- Straight bill model (size range DN80 to DN300)
- Curved bill model (size range DN80 to DN2400).
- The shape and dimensions can be changed to suit specific requirements.
- Flange drilling can be according to AS2129 Table D/E and more.

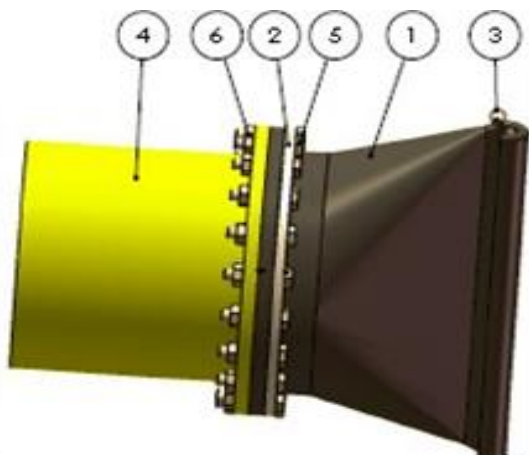

Item	Part	Material
1	Valve	Neoprene/EPDM/Nitrile
2	Ring Flange	CS/SS/DI/PVC, etc.
3	Eye Bolt*	SS316 on request
4	Pipe & Flange	CS/SS/DI/PVC, etc.
5	Bolt	Not supplied
6	Nut	Not supplied

## Data Sheet:

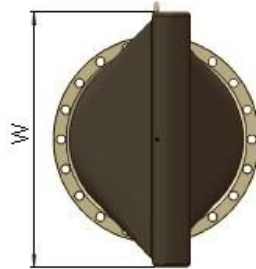
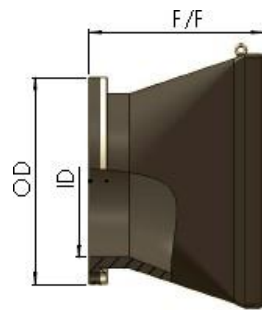

Flared model to be specified

Available from size DN80(3")

DN	150	200	250	300	350	400	450	500	600	700	800
OD	285	340	395	445	505	565	615	670	780	895	1015
F/F	215	350	455	495	620	660	690	760	920	1120	1180
W	254	345	455	480	600	680	750	850	980	1130	1250
Weight(kg)	7	11	19	28	41	50	66	83	122	205	TBA
DN	900	1000	1200	1400	1500	1600	1800	2000	2200	2400	
OD	1115	1230	1405	1630	1720	1830	2045	2265	2475	2685	
F/F	1110	1350	1400	1600	1600	1860	1630	1630	2147	2604	
W	1170	1450	1800	1900	2070	2080	2360	2700	3500	3838	
Weight(kg)	TBA	TBA	TBA	TBA	TBA	TBA	TBA	TBA	TBA	TBA	

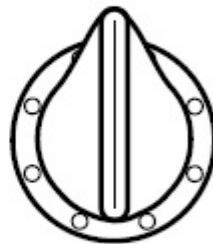
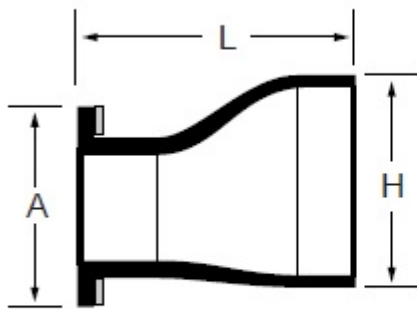

Flat bottom model shown, with flared top

# DB-2 Flanged Duckbill Check Valve

## - Straight duckbill model



The straight duckbill model of DB-2 flanged duckbill check valve is available in size range DN80(3") to DN300(12").

Flange specifications such as AS2129 Table D/E and more.

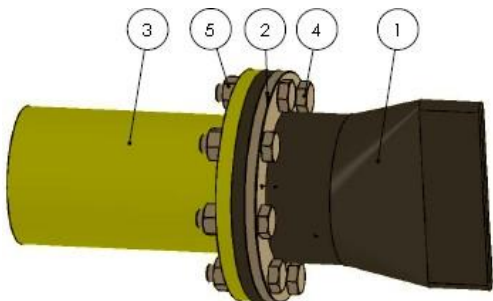

Item	Part	Material
1	Valve	Neoprene/EPDM/Nitrile
2	Ring Flange	CS/SS/DI/PVC, etc.
3	Pipe & Flange	CS/SS/DI/PVC, etc.
4	Bolt	Not Supplied
5	Nut	Not Supplied

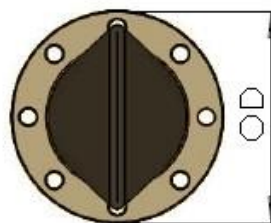
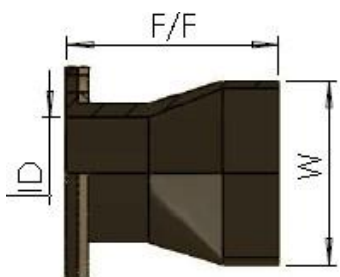

Flared model to be specified

DN						80	100	125	150	200	250	300
F/F						180	210	240	215	350	455	495
OD						200	220	250	285	340	405	460
ID						80	100	125	150	200	250	300
W						140	175	210	254	345	455	480
Weight(kg)						4	5	6	7	11	19	28